

Helmet Manual

Congratulations on purchasing your new ROYAL helmet!

Please read these instructions carefully before using your new helmet.

This manual of care and user instructions has information which will help you to obtain maximum protection from your helmet as well as extend its usable life.

All ROYAL products are the result of the most advanced research in terms of riding safety, testing and design. The highest level of aerodynamics and comfort will offer you the best performance on the road.

Whatever style you choose, all ROYAL helmets are designed to offer the best in protection, safety and comfort providing the safest, most rewarding and enjoyable riding experience possible.

Enjoy!

3



WARNING BEFORE USE

Wearing an improperly fitting helmet could increase your risk of serious injury or death in an accident. Follow the instructions that follow for checking the correct fitting of your motorcycle helmet. If you need additional assistance, contact the retailer you purchased the helmet from or go to **royal-helmet.com** for detailed sizing and fit instructions.

We recommend you to use it during your journey by motorbike on street, off-road. to ensure safety.

HOW TO PROPERLY FIT A MOTORCYCLE HELMET

Motorcycle helmets are an important piece of safety equipment that could help protect and/or possibly save a rider's life. A properly fitted helmet is critical to the safety of every rider and passenger. You are responsible for your own safety! No helmet can protect the wearer against all possible or foreseeable impacts.

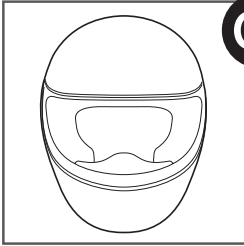

01

SELECT A HELMET

Use your existing helmet size (or estimate) as a gauge to start the fitting process. The helmet's size label is sewn onto the helmet's interior comfort liner.

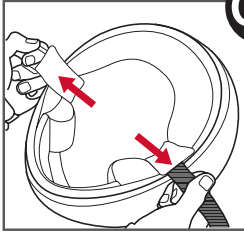

02

TRY ON THE HELMET

Hold the helmet in front of you. The helmet bottom should face you with the front pointing down. Hold the helmet retention system straps and pull outward slightly. This gives your ears a bit more clearance when pulling on a full or open face helmet. Pull the helmet onto your head. Check your field of vision. Your vision should not be obstructed or blocked when looking up, down, left or right.

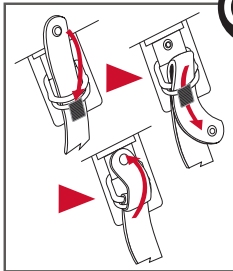

03

SECURELY FASTEN THE HELMET

Fasten the retention system as tightly as possible under your jaw without causing pain. There must be no slack in the retention system and it must be snug up against your jaw. If the retention system is not tight, your helmet may become dislodged or knocked off in an accident. If your retention system has a snap on the strap, do not rely on it to secure the helmet. The snap is provided only to prevent the strap end from flapping in the air. Fasten the retention as shown.



04 ENSURE A SNUG FIT

With the tightened retention system secure under your jaw, take hold of the helmet with a hand on each side. Without moving your head, try to move the helmet up and down and side to side. The helmet should fit as snug as possible around the crown of your head and settle onto the top of your head. If there is a gap between the top of your head and the inside ceiling of the helmet, the helmet is too small. If you can move the helmet around easily, it is too big.

When moving a proper fitting full or open face helmet, your face, cheek and scalp skin should move with the helmet liner.

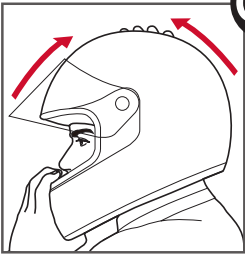

05 CHECK FOR ADEQUATE RETENTION

With the retention system secure under your jaw, take hold of your helmet at the back. Try pushing the helmet off by rotating it forward. Then put your hands on the front of the helmet and try pushing the helmet off by rotating it toward the rear. If the helmet is close to coming off in either direction, covers your eyes or touches your nose, please try another size.

HELMET CARE AND MAINTENANCE

Improper care and maintenance can damage your helmet and could increase your risk of serious injury or death in an accident.

Only clean with mild soap and water or a cleaner designed for motorcycle helmets.

Never use petrochemicals, glass cleaners, ammonia, bleach, gasoline, paint thinner, benzene, acetone, bug repellent, acid-based, alkali-based or any other harsh cleaner or solvent. Keep helmet away from fumes of such products. Use of those or similar products and their fumes can cause damage to the helmet's shell, face shield, interior comfort liner, protective EPS foam and other components. This damage may not be visible. Please read the instructions that follow for more information on how to clean the different helmet components.

Store your helmet in a cool dry place. Keep away from heat in excess of 120° F and do not set near hot surfaces. Keep away from pets and animals.

Store your helmet in a cool dry place. Keep away from heat in excess of 88°C and do not set near hot surfaces. Keep away from pets and animals.

Never modify your helmet in any way. This includes, but is not limited to:

- Drilling holes
- Cutting the shell, liner or straps
- Modifying the retention system including adding a chin cup or quick release mechanism
- Removing parts
- Painting
- Attaching accessories that are not made specifically for the make and model of helmet
- Cutting or removing rubber trim
- Removal or modification of the internal EPS foam

Make sure you can see clearly through the face shield before riding.

HELMET CLEANING INSTRUCTIONS

Face Shield:

Clean the face shield on a regular basis. It is best and easiest to remove bugs and dirt immediately after use. Remove the shield from the helmet before cleaning. Use a cleaner designed for use on helmet face shields or use warm water, non-abrasive hand or dish soap and a clean soft cloth. Use only light pressure to remove dirt. Blot dry. Do not use paper products or paper towels to clean or dry the face shield as this will scratch it. Before reinstalling the face shield inspect the shield base plates. Clean the base plates and snug the screws as needed.

Interior Comfort Liner:

Cleaning the helmets interior liner with motorcycle helmet cleaner can help reduce odor caused by bacteria and mildew as well as keep your helmet feeling and smelling fresh.

Non-Removable Liner:

Be very careful when cleaning non-removable helmet liners. Improper cleaning may damage the adhesives that hold the liner in place. It is best to use a cleaner designed for washing motorcycle helmet liners. Gently hand wash the liner. Thoroughly rinse any cleaning agent. Blot with a clean cloth or towel to absorb as much water as possible then air dry.

Removeable Liner:

Remove the liner from the helmet. Use a cleaner designed for washing motorcycle helmet liners or use mild hair shampoo. Gently hand wash the liner. Thoroughly rinse any cleaning agent. Blot with a clean cloth or towel to absorb as much water as possible and then air dry. Do not put the liner in the dryer.

Interior Safety EPS Foam:

Use extreme care cleaning this impact absorbing part of the helmet. The EPS foam can be easily damaged. Press very softly and use only warm water and a dry cloth. Blot dry with a soft cloth or towel. Never apply heat or solvents.

Exterior (Outer) Shell / Gloss Finish:

Use a cleaner designed for motorcycle helmet shells or use warm water, non-abrasive hand or dish soap and a clean soft cloth. Use only light pressure to remove dirt. Thoroughly rinse any cleaning agent and blot dry. Do not use paper products to clean or dry, as they will scratch it.

Exterior (Outer) Shell / Non-Gloss, Matte Finish:

Use warm water, non-abrasive hand or dish soap and a clean soft cloth. Use only light pressure to remove dirt. Thoroughly rinse any cleaning agent and blot dry. Do not use paper products to clean or dry, as they will scratch it. Excessive pressure, using other cleaning agents, waxes or polish may alter the finish to look wet or glossy.

Vent Cleaning:

Dirt and debris can find its way into the venting of the helmet. Remove the interior liner if possible. Use a compressed air can typically used to clean computer keyboards. Do not use high-pressure air. The compressed air should blow the dirt and debris out of the vent.

WARRANTY POLICY

All Royal helmet products carry a two (2) year guarantee on materials and workmanship. If a Royal helmet product fails to Perform due to a defect in either aspect, royal will repair Or replace the item at our discretion for two (2) years from date of purchase. This guarantee does not cover damage due to accident, misuse, negligence or normal wear, including the natural breakdown of materials and colors over time and use.

All feedback please contact us via the information below:

Head Office

Lot K1-K5 N1 Road, Lot K26-K30 Provincial Road 823D, Nam Thuan Industrial Park, Duc Hoa Dong Commune, Duc Hoa District, Long An Province

Group Office

Lot C7/II, Road No. 2E, Vinh Loc Industrial Park, Vinh Loc A Commune, Binh Chanh District, Ho Chi Minh City

www.royal-helmet.com